



X-TREME FINISHER STAND DRYER

OWNER'S MANUAL

Model No.B-18

XPOWER MANUFACTURE, INC.
220 Clary Avenue
San Gabriel, CA 91776, USA
Tel: 626-285-3301
Fax: 626-285-3302



PLEASE READ AND SAVE THESE INSTRUCTIONS

Table of Contents

Introduction	2
Operation	3
Instructions for Special Features	3
Adjustment / Accessories	4
Specifications / Assembly	5
Parts List	6
Installation Tips and Hints	7
Safety Instructions	8
Maintenance / Troubleshooting	9
Warranty / Service	10
Registration Form	11

Introduction

The XPOWER B-18 X-TREME Stand Dryer gives you a “hands free” option when it comes to grooming. We made the best stand dryer in the market even better! The B-18 is the big brother to the B-16, and boasts more power and more heat to finish faster with professional salon results. The 1/3 HP motor provides plenty of power and with the electronic variable speed switch and dual heat settings, the B-18 gives you complete control of air flow and temperature. The anion switch neutralizes the static electricity making coat management easier and job completion faster. The durable ABS housing helps your machine last longer and the easy access filter system keeps your motor running smooth.

Special Features

- Remarkably QUIET and Lightweight
- Powerful and Energy-Efficient BRUSHLESS DC MOTOR
- Variable Speed Control
- Anion Technology to Reduce Static Electricity
- Dual Heat Settings
- 360° Flexible and Rotating Nozzles
- Patented 5-Legged Base Design with Lockable Casters
- Self-Rising Adjustment Stand (Up to 5 ft.)
- Tilt-Head Design for Different Angle Positions
- Washable Filters
- Durable & Rugged ABS Housing
- Thermally Protected
- 1 Year Limited Warranty

Operation

XPOWER B-18 Stand Dryers are designed for hands-free pet styling drying.

1. Carefully follow the assembly instructions. Inspect the unit completely for any shipping damages or missing parts.
2. Upon assembly, place the dryer on a flat surface. Plug the electrical cord into a 3-prong GFCI outlet.
3. Turn on the AIR FLOW switch to desired speed.
4. If heat is required, turn heat switch to position 1 (for low heat) or position 2 (for high heat).
5. Use the stand adjustment handle to set the desired height and tighten to secure.
6. All units in use must be monitored at all times.

Instructions for Special Features

Heat Switch:

Position 1 for low heat.
Position 2 for high heat.

Select desired temperature setting.



Air Flow Switch:

The Air Flow Control is also the **ON / OFF** switch.

Anion Switch:

The Anion Function offers **ANION** low static air flow during Grooming.

Adjustment / Accessories



Turn handles at both side of Pet Dryer (clockwise to tighten, counter- clockwise to loosen).



Tiltable head for different angle positions



let dry thoroughly before reinstalling.

Self-Rising adjustment stand for height adjustment (up to 5ft.)



Accessories - Filter

A filter is included in the XPOWER B-18 Stand Dryer, which will help prevent small debris and pet hair from entering the motor. To clean the filter, remove the filter from the unit and wash with mild soap and warm water. Rinse with clean water and let dry thoroughly before reassembling (extra filter included)



Filter located at the bottom of motor

Specifications

Volt / Cycle	115V / 60Hz	Cord Length	13 Ft.
Horse Power	1/3 HP	Rated Airflow	380 CFM
Max. Amp	18 Amps.	Heater	Duo Setting
Weight	18 Lbs.	Housing	ABS
Speeds	Variable	Filter System	YES
Motor	Brushless DC	ANION	YES

Assembly

1. Unfold the patented 5-legged base and attach the five lockable casters to the legs.
2. Attach the self-rising adjustment stand pipe to the base by screwing the pipe to the center screw in the base.
3. Attach the dryer motor to the top end of the stand pipe and tighten.
4. Attach the straight hose to the dryer motor assembly.
5. Plug in the unit, turn on the airflow switch and begin using your XPOWER Stand Dryer.

Dryers Parts List

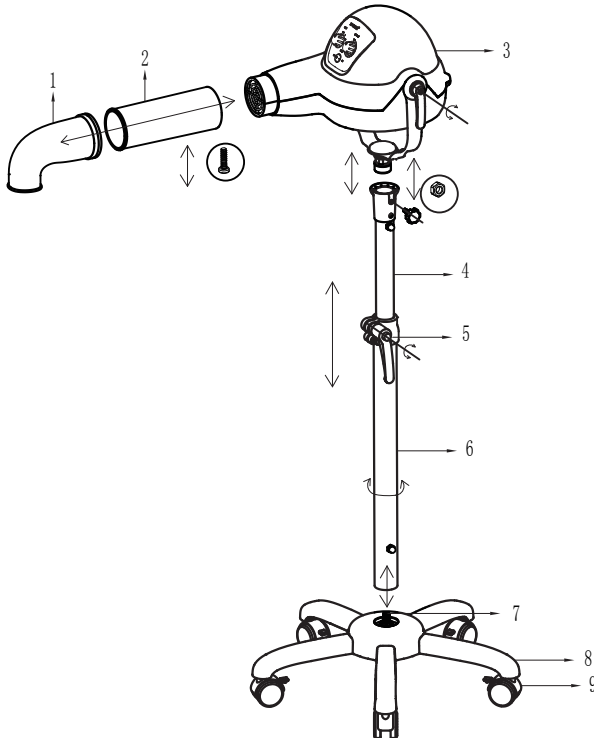

Item No.	Parts Name
1	Air outlet nozzle
2	Straight hose
3	Dryer motor assembly
4	Upper stand pipe
5	Height adjustment handle
6	Lower stand pipe
7	Stand base screw
8	Foldable stand legs
9	Lockable Casters

Installation Tips and Hints

Part #8 & #9

Open Foldable Stand Legs and push Lockable Casters in to Foldable Stand Legs.

Part # 6 & # 7

Make sure parts 6 & 7 are screwed together tightly until the pipe comes in contact with the foot stand (do not force, may cause screw to be stripped).

Part #3 & #4

Connect Upper Stand Pipe to Dryer Motor Assembly.

Part # 2 & # 3

There are notches on both straight hose and dryer motor assembly arm. Assemble and align them properly before joining them together, then screw them in tightly.

Safety Instructions

WARNING: IMPORTANT SAFETY PRECAUTIONS!

PLEASE READ COMPLETELY BEFORE USING PRODUCT!

When using electrical appliances, especially when children or animals are present, basic safety precautions should always be followed to reduce the risk of fire, electric shock, and personal injury. These include, but are not limited to the following:

- Do not leave the dryer and animal unattended while the product is in use.
- Unplug dryer when not in use.
- Do not use extension cords with the product.
- Do not unplug unit by pulling on cord.
- Do not expose dryer to rain or water.
- Unplug unit before attempting any maintenance or service.
- Do not let air-intake get clogged.
- Do not direct dryer air towards eyes or ears of people or pets.
- Never use dryer with a damaged cord/plug or when unit has been dropped, damaged, or exposed to rain/water. Please call our Technical Department for service or repair.
- Do not use any other nozzles not intended for use with the dryer.
- Do not operate without filter in place. Keep filter clean, as a dirty filter limits air intake and may damage the motor or cause overheating.
- Plug only into a properly grounded receptacle. Always confirm that the amperage rating of the electrical outlet complies with the Dryer rating.
- Do not use product for anything other than its intended purpose.
- Do not attempt to perform any service or maintenance not outlined in the instruction manual.

Maintenance Instructions

- To keep the dryer clean, use a damp cloth to wipe the surface of the housing. Removable part(s) and filters may be cleaned with water and dried thoroughly before reassembling.
- When not in use, unplug and store the XPOWER Pet Dryer in a dry indoor place out of reach of children.
- Always disconnect the XPOWER Pet Dryer from its power source before performing any maintenance or cleaning.
- Clean the filter often to avoid loss of airflow.

Troubleshooting

For any problems not listed below, call your local distributor or contact our Service Department.

PROBLEM	POSSIBLE CAUSE	SOLUTION
Stand Dryer not running	No power input	Plug in the dryer; check circuit breaker
	Air Flow Switch not turned on	Turn on the Air Flow switch
	Unit fan jammed	Contact our Service Department
Dryer vibrates excessively	Fan unbalanced	Contact our Service Department

XPOWER Limited Warranty

XPOWER Manufacture, Inc. warrants this product to be free from defects in material and workmanship for a period of one (1) year from the date of original purchase. Wearable parts including but without limitation, filters, motor brushes, hoses and power cords are excluded from the warranty. The liability of XPOWER is limited solely to the cost of the repair or replacement of parts/the unit at XPOWER's discretion. This warranty does not cover normal wear of parts and does not apply to any unit that has been tampered with or used for commercial purposes. This limited warranty does not cover damage caused by misuse, abuse, negligent handling or damage due to faulty packaging or mishandling in transit. This warranty does not cover damage or defects caused by or resulting from damages from shipping or repairs, service or alterations to the product or any of its parts, which have been performed by a repair person not authorized by XPOWER.

Limitations and Exclusions

If any part or device manufactured by XPOWER Manufacture, Inc. is repaired or replaced, the new/repaired machine and/or part(s) shall be warranted only for the remainder of the original warranty period.

Service

For Warranty service and parts replacement (US users only), you must:

- A. Call 1-855-855-8868 for a RMA (Return-Merchandise-Authorization) number.**
- B. Have original proof of purchase.**
- C. Use the original undamaged packaging or an Industrial certified packaging method.**

The end user will be responsible to ship the unit (with RMA Number showing on the shipping label) to the XPOWER Service Department. XPOWER to inspect, assess and advise the repairs needed and the applicable cost, if any.

For users outside the US, please contact XPOWER Distributor in your country or region for Warranty service and parts replacement.

WARRANTY REGISTRATION (for US user only)

Please complete and mail or fax for your product warranty. For multiple units, please list serial numbers on a separate sheet of paper.

Address: XPOWER MANUFACTURE, INC. 220 Clary Avenue San Gabriel, CA 91776, USA

Tel: 626-285-3301, Fax: 626-285-3302

Your Name / Company Name _____

Contact Name _____ **Title** _____

Address _____ **City** _____ **State** _____ **Zip** _____

Phone _____ **Fax** _____ **E-mail** _____

Stand Dryer Model # _____ **Serial # :** _____

Date of Purchase ____/____/____ **Purchased From** _____



From: _____

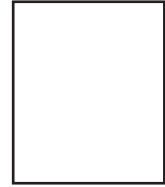

TO:
XPOWER MANUFACTURE, INC.
220 Clary Avenue
San Gabriel, CA 91776, USA
Tel: 626-285-3301, Fax: 626-285-3302



XPOWER Pet Dryers available in US market

Force Dryers (B-2, B-3, B-4 and B-5 with vacuuming feature)

B-2 (2 HP / 8 Amps / 100 CFM) - for home use

B-3 (2 HP / 8 Amps / 100 CFM)

B-4 (3 HP / 10 Amps / 120 CFM)

B-5 (4 HP / 12 Amps / 140 CFM)

B-24 (3 HP / 14 Amps / 150 CFM) - with heater

B-27 (6 HP / 20 Amps / 180 CFM) - double motor

Stand Dryers

B-16 (1/4 HP / 12 Amps / 300 CFM)

B-18 (1/3 HP / 18 Amps / 380 CFM)

Cage Dryers

X-430TF w/ 430MDK (1/3 HP / 3.8 Amps / 2000 CFM)

X-800TF w/ 800MDK (3/4 HP / 7.5 Amps / 3200 CFM)



visit XPOWER.WS for detailed information

